

2220
2520

Guides plate, VDI 3357
导板, VDI 3357



2220



2520



A

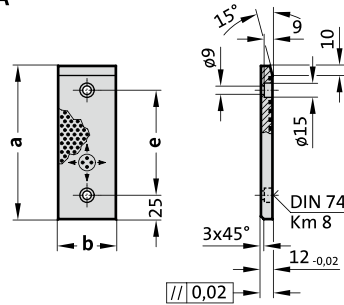

B

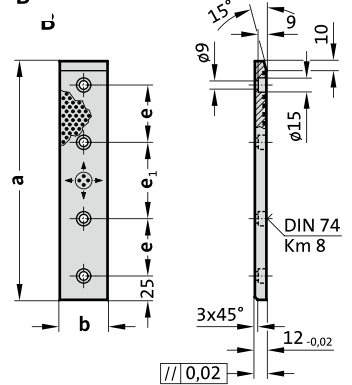

Material 材料:

2220: CuZn25Al5Fe3Mn3 + 固体润滑剂
Solid lubricant

2520: 钢 Steel

2520: 55~60HRC

Description 说明:

2511: 表面高频处理 Surface high frequency processing

硬度 Hardness:

2220: ≥210HB

2520: 55~60HRC

2220. Guides plate, VDI 3357
2220. 导板, VDI 3357

形状	b	a	e	e ₁	螺栓孔数量
A	30	80	30	-	2
A	30	100	50	-	2
A	30	125	75	-	2
A	30	160	110	-	2
A	30	200	150	-	2
A	30	225	175	-	2
B	30	250	60	80	4
B	30	260	60	90	4
B	30	280	60	110	4
B	30	300	80	90	4
B	30	320	80	110	4
A	40	80	30	-	2
A	40	100	50	-	2
A	40	125	75	-	2
A	40	160	110	-	2
A	40	200	150	-	2
A	40	200	150	-	2
A	50	80	30	-	2
A	50	100	50	-	2
A	50	125	75	-	2
A	50	160	110	-	2
A	50	200	150	-	2
A	50	225	175	-	2
B	50	250	60	80	4
B	50	300	80	90	4

2220. Guides plate, VDI 3357
2220. 导板, VDI 3357

形状	b	a	e	e ₁	螺栓孔数量
B	50	350	100	100	4
B	50	400	120	110	4
A	60	80	30	-	2
A	60	100	50	-	2
A	60	125	75	-	2
A	60	160	110	-	2
A	60	200	150	-	2
A	60	225	175	-	2
B	60	240	60	70	4
B	60	250	60	80	4
B	60	260	60	90	4
B	60	280	60	110	4
A	80	80	30	-	2
A	80	100	50	-	2
A	80	125	75	-	2
A	80	160	110	-	2
A	80	200	150	-	2
A	80	225	175	-	2
B	80	240	60	70	4
B	80	250	60	80	4
B	80	260	60	90	4
B	80	280	60	110	4
B	100	240	60	70	4
B	100	260	60	90	4
B	100	280	60	110	4

Order 订购 Catalog No. 目录号 b a 厚度

2220 030 080 012

2520 030 080 012