

5220
5920

Sleeve Bushing Specification & Tolerance
轴套规格及公差

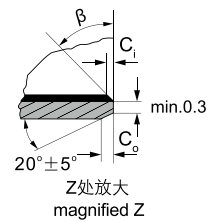
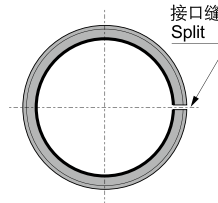
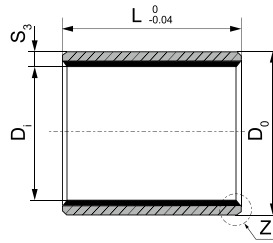

内外倒角 ID and OD chamfers

S ₃	C _o	C _i	β
0.75	0.5±0.3	0.25±0.2	30°±5°
1.00	0.6±0.3	0.30±0.2	30°±5°
1.50	0.7±0.3	0.50±0.3	30°±5°

S ₃	C _o	C _i	β
2.00	1.2±0.4	0.50±0.3	30°±5°
2.50	1.8±0.6	0.60±0.3	45°±5°

单位Unit: mm

5920 Sleeve Bushing Specification & Tolerance
5920 轴套规格及公差

轴径 (f7) Shaft Ds	6	8	10	12	13	14	15	16	17	18	20	22	24	25	28	30	32	35	38	40	45	50	55	60
Ds	-0.010 -0.022	-0.013 -0.028					-0.016 -0.034							-0.020 -0.041				-0.025 -0.050			-0.050 -0.025		-0.060 -0.030	
座孔 (H7) Housing DH	8	10	12	14	15	16	17	18	19	20	23	25	27	28	32	34	36	39	42	44	50	55	60	65
DH	+0.015 +0.000				+0.018 +0.000						+0.021 +0.000							+0.025 +0.000					+0.030 +0.000	
(OD) 外径公差 Tolerance DO	8	10	12	14	15	16	17	18	19	20	23	25	27	28	32	34	36	39	42	44	50	55	60	65
DO	+0.055 +0.025				+0.065 +0.030						+0.075 +0.035							+0.085 +0.045					+0.100 +0.055	
(ID) 压装后 内孔公差 After fixed Di,a	6	8	10	12	13	14	15	16	17	18	20	22	24	25	28	30	32	35	38	40	45	50	55	60
Di,a	+0.055 -0.010				+0.058 -0.010					+0.61 -0.010		+0.071 -0.010			+0.085 -0.010			+0.085 -0.010			+0.105 -0.010		+0.110 -0.010	
壁厚 Wall thick- ness S3	1.0 +0.005 -0.020								1.5 +0.005 -0.025				2.0 +0.005 -0.030				2.5 +0.005 -0.040							
配合间隙 Clearance DD	0.077 0.000	0.083 0.003	0.086 0.003			0.092 0.006				0.095 0.006				0.112 0.010		0.126 0.010		0.135 0.015			0.155 0.015	0.160 0.015	0.170 0.020	
6	●	●	●	●																				
8	●	●	●	●																				
10	●	●	●	●	●	●	●	●	●	●	●	●	●	●										
12		●	●	●	●	●	●	●	●	●	●	●	●	●	●	●	●	●	●	●				
15		●	●	●	●	●	●	●	●	●	●	●	●	●	●	●	●	●	●	●				
20			●	●	●	●	●	●	●	●	●	●	●	●	●	●	●	●	●	●				
25				●	●	●	●	●	●	●	●	●	●	●	●	●	●	●	●	●				
30											●	●	●	●	●	●	●	●	●	●				
40												●	●	●	●	●	●	●	●	●				
50														●	●	●	●	●	●	●				
60																					●	●	●	●
70																						●	●	●
80																							●	●
100																								●
115																								

5220 5920

Sleeve Bushing Specification & Tolerance 轴套规格及公差

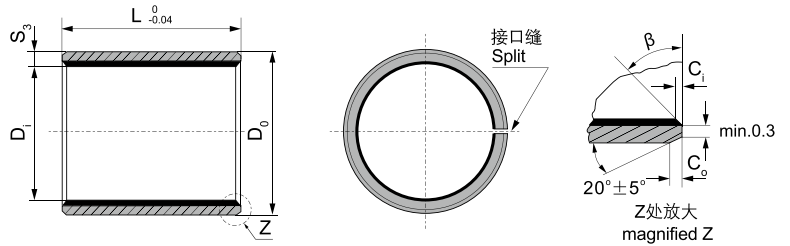

内外倒角 ID and OD chamfers

S ₃	C _o	C _i	β
0.75	0.5±0.3	0.25±0.2	30°±5°
1.00	0.6±0.3	0.30±0.2	30°±5°
1.50	0.7±0.3	0.50±0.3	30°±5°

S ₃	C _o	C _i	β
2.00	1.2±0.4	0.50±0.3	30°±5°
2.50	1.8±0.6	0.60±0.3	45°±5°

单位Unit: mm

5920 Sleeve Bushing Specification & Tolerance 5920 轴套规格及公差

轴径 (F7) Shaft Ds	65	70	75	80	85	90	95	100	105	110	120	125	130	135	140	150	160	180	190	200	220	250	260	280	300		
座孔 (H7) Housing DH	70	75	80	85	90	95	100	105	110	115	125	130	135	145	155	165	185	195	205	225	255	265	285	305			
(OD) 外径公差 Tolerance DO	70	75	80	85	90	95	100	105	110	115	125	130	135	145	155	165	185	195	205	225	255	265	285	305			
(ID) 压装后 内孔公差 After fixed Di,a	65	70	75	80	85	90	95	100	105	110	120	125	130	140	150	160	180	190	200	220	250	260	280	300			
壁厚 Wall thick- ness S3	2.5	+0.005 -0.040		2.5							-0.01 -0.060		2.5													-0.035 -0.085	
配合间隙 Clearance DD	0.170 0.020		0.201 0.020		0.209 0.020			0.264 0.070				0.273 0.070			0.279 0.070		0.288 0.070		0.294 0.070		0.030 0.070						
6																											
8																											
10																											
12																											
15																											
20																											
25																											
30	●	●	●																								
40	●	●	●	●	●	●																					
50	●	●	●	●	●	●	●	●	●	●	●	●	●	●	●	●	●	●	●	●	●	●	●	●	●		
60	●	●	●	●	●	●	●	●	●	●	●	●	●	●	●	●	●	●	●	●	●	●	●	●	●		
70	●	●	●	●	●	●	●	●	●	●	●	●	●	●	●	●	●	●	●	●	●	●	●	●	●		
80		●	●	●	●	●	●	●	●	●	●	●	●	●	●	●	●	●	●	●	●	●	●	●	●		
100				●	●	●	●	●	●	●	●	●	●	●	●	●	●	●	●	●	●	●	●	●	●		
115																											



Order 订购

Catalog No. 目录号

D_i

D_o

L

5220 : 020 : 023 : 020
5920 : 020 : 023 : 020